

# CARD-O-PULLS™

## Printed Circuit Board Card Ejectors & Handles

### Material Specifications:

White Nylon, per ASTM D 4066 PA111  
U.L. Rated 94V-2

### Oxygen Rating Index:

Over 28%

### Ordering Information:

CP-XX GN PA  
 Pre-Assembled Pin  
 Color (WE for White)  
 Base Part

### Standard Drawing Tolerances:

(unless otherwise indicated)

Fractions:  $\pm 1/64$  (0.4)  
 .X =  $\pm 0.10$  (2.5)  
 .XX =  $\pm 0.01$  (0.25)  
 .XXX =  $\pm 0.005$  (0.13)

Note: Passivated Stainless Steel Spring Pins per MIL-P-10971 furnished with each Ejector or Inserter/Extractor.

### Spring Pin

Part No.	L	D
RP-250	1/4 (6.4)	3/32 (2.4)
RP-312	5/16 (8.0)	3/32 (2.4)
RP-375	3/8 (9.5)	1/8 (3.2)

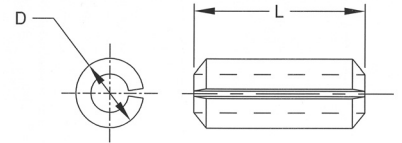

### LP-06 Series

RP-250 Pin. WE for white or specify color

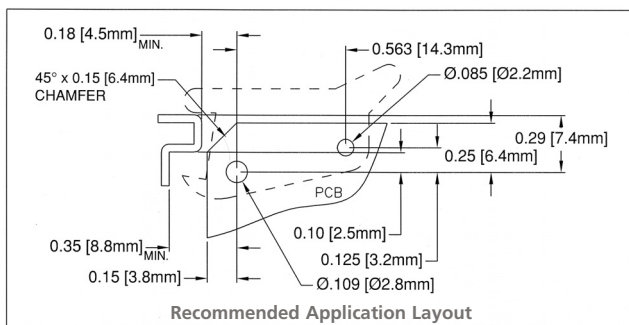
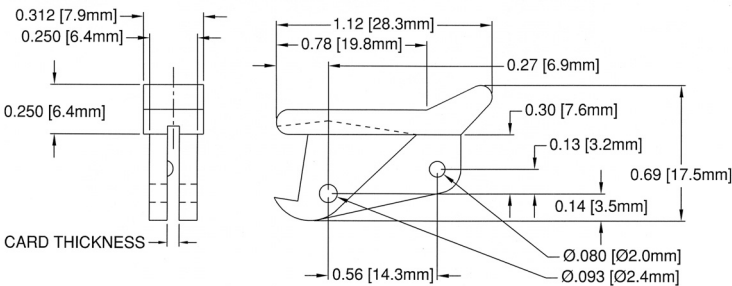

### LP-36 Series

RP-250 Pin. WE for white or specify color

